

Full Bore - Slurry Valve

F-21 Plug Valve

FEATURES:

- Full Bore
- Cavity Free
- Quarter Turn
- Piggable
- Manual or Automated

2 Way, 3 Way and Custom Made to order

Materials of construction include Carbon Steel, 304SS, 316SS, 254SMO, Hastelloy®, Monel® and a variety of other special alloys.

Replace troublesome Ball or Gate Valves that choke and become inoperable.

No cavity or "dead space" that can become filled with solids and prevent the valve from cycling.

The ICON Full Bore Slurry Valve is suitable for all types of abrasive slurries and/or pneumatic transfer lines including Lime, Bauxite, Coal, Cement, Fly Ash, Mineral Sands etc as well as scale forming liquours and vapours.

Icon's Full Bore Slurry Valve was originally designed for high temperature lime slurry lines where pipes and valves become choked with solids. Pigging helps clear pipelines, however any valve with internal cavities simply cannot cope with the concrete-like solids that adhere internally and simply will not cycle.

The Fig 21 Full Bore Plug Valve has no internal cavities and cycles every time !

Full Range of Operators and Accessories:

Gear Operator (standard), Air - Hydraulic - Spring Actuators, Electric Motors, Control Accessories, Extensions etc

Options:

Lock-out facility, Internal hard facing coatings including ceramic, composites and hard metals.

Hastelloy® is a registered trademark of Haynes International

Monel® is a registered trademark of International Nickel Company

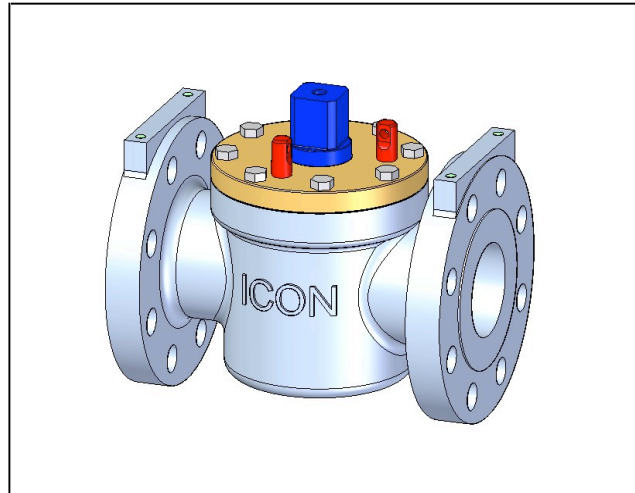

Distributed by:

The Slurry Valve Specialists !